



Oakfields

Coleford, Gloucestershire, GL16 8EN

£120,000



*****CALLING ALL INVESTORS***** A spacious & well presented ground floor apartment offering an excellent opportunity for investors. The accommodation comprises a generous lounge filled with natural light, a well-appointed fitted kitchen providing ample cupboard and worktop space, a good-sized double bedroom & bathroom fitted with a three-piece suite.

Outside, the property benefits from a private rear garden laid mainly to lawn with raised planting beds, offering excellent potential to create an attractive outdoor entertaining space. Further benefits include useful external storage, communal parking and pleasant open green spaces nearby, creating a peaceful setting while remaining conveniently located for local amenities.

Approached via front door into:

Entrance Hallway:
7'5" x 2'10" (2.27m x 0.87m)

Three storage cupboards, airing cupboard housing gas boiler and hot water tank, radiator, thermostat for central heating system.

Kitchen:
8'7" x 8'5" (2.64m x 2.57m)

A range of wall units & base units, rolled edge work surfaces, inset stainless steel sink unit with tap & drainer, integrated electric oven & hob with extractor hood over, tiled splashbacks, panelled radiator, double glazed window to rear.

Lounge:
12'5" x 11'6" (3.79m x 3.51m)

Rear & side aspect with double glazed windows to rear & side, double panelled radiator, BT & TV points.

Bedroom:
11'6" x 10'7" (3.53m x 3.24m)

Double glazed window to the front, panelled radiator.

Bathroom:
6'8" x 5'4" (2.04m x 1.64m)

Three piece white suite comprising low level W.C., pedestal wash hand basin, panelled bath, obscured double glazed window to front, panelled radiator.

Outside:
The property benefits from a gravelled terraced garden to the front & lawned garden to the side.

Area Map



Floor Plan

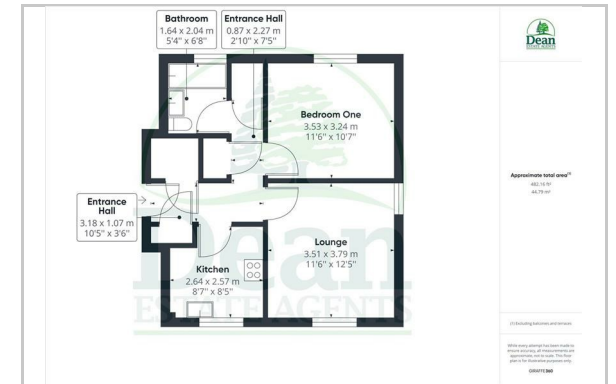

Energy Efficiency Graph

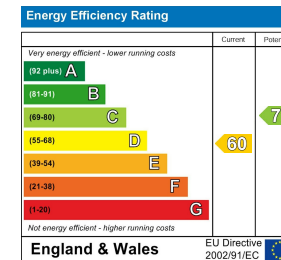

Consumer Notes: Dean Estate Agents Ltd have prepared the information within this website/brochure with care and co-operation from the seller. It is intended to be indicative rather than definitive, without a guarantee of accuracy. Before you act upon any information provided, we request that you satisfy yourself about the completeness, accuracy, reliability, suitability or availability with respect to the website or the information, products, services, or related graphics contained on the website for any purpose.

These details do not constitute any part of any Offer, Contract or Tenancy Agreement.

Photographs used for advertising purposes may not necessarily be the most recent photographs, although every effort is made to update photographs at the earliest opportunity. Any reliance you place on such information is therefore strictly at your own risk. All photographic images are under the ownership of Dean Estate Agents Ltd and therefore Dean Estate Agents retain the copyright. You must obtain permission from the owner of the images to reproduce them.

Tenanted Property – we are not always able to show the most recent condition of a property due to tenants' privacy and we may choose to show the photographs of the property when it was last vacant to at least allow clients some idea of the internal condition. Therefore, we would of course, urge you to view before making any decisions to purchase or rent the property and before any costs.

Energy Performance Certificates are supplied to us via a third party and we do not accept responsibility for the content within such reports.

PRC Certificates – Some ex-local authority properties have been repaired in recent years using the PRC Scheme wherein a certificate has been produced by a qualified property engineer. This certificate does not imply the suitability for a mortgage approval and you must satisfy yourself of the work carried out that may meet your lenders criteria.

As with leasehold property or new build development sites, you are likely to be responsible for a contribution to management charges and/or ground rent or a contribution to the development service charge. Please enquire at the time of viewing.